

## SEAT

Designer: Aaron Tuck



### SLAT OPTIONS

- Oiled hardwood
- Composite
- Clear anodised aluminium
- Wood grain aluminium

### FRAME OPTIONS

- Hot dip galvanised mild steel

### FRAME FINISHES

- Powdercoat

### INSTALLATION

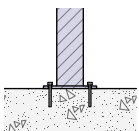

Bolt Down

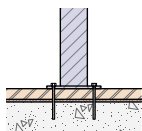

Bolt Through

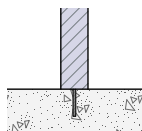

Concealed Fix

### FIXINGS

- 12mm fixings for 14mm diameter holes

Alternative materials and finishes available on request

# GATEWAY SEAT

## SPECIFICATIONS

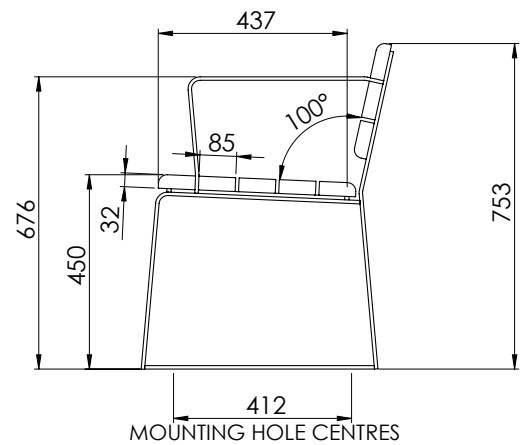
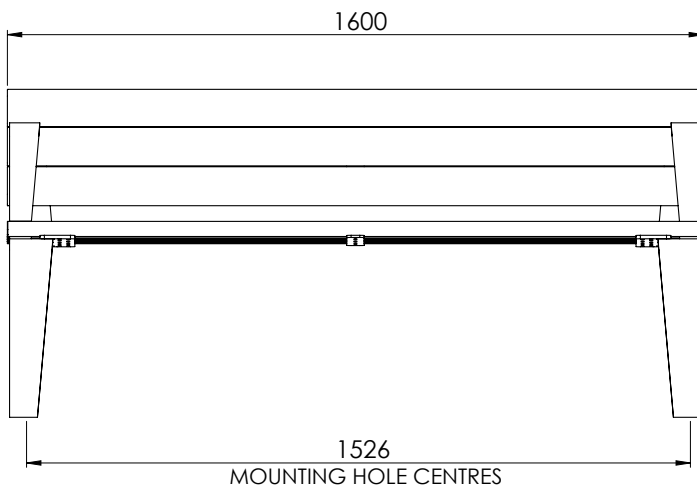
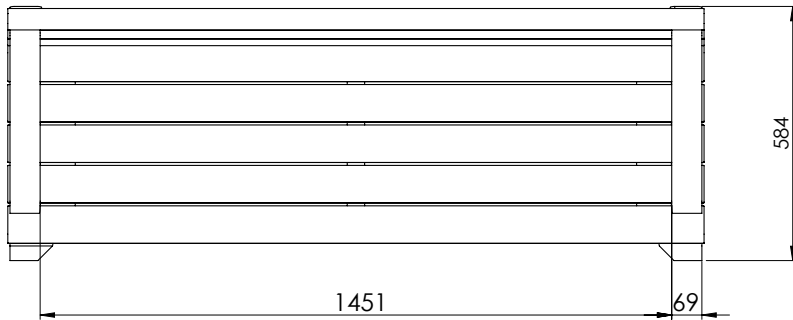

All measurements are in millimetres. Drawings are not to scale  
Dimensions shown are for timber slat option.

PRODUCT CODE	FRAME FINISH	SLAT OPTION & SIZE (mm)
GAT003-HDG-PC-T	Powdercoated	85x32 Oiled hardwood timber
GAT003-HDG-PC-C	Powdercoated	90x40 Composite
GAT003-HDG-PC-A	Powdercoated	65x35 Clear aluminium
GAT003-HDG-PC-W	Powdercoated	65x35 Wood grain aluminium